

# COMPANY INTRODUCTION

We are a specialized enterprise integrating production, research and development, and marketing. The company covers an area of over 50,000 square meters and employs more than 100 people.

We have our own brand, which enjoys a high reputation in both domestic and foreign markets. Our products sell well throughout the country and are exported to many countries and regions such as Europe, the Middle East, Southeast Asia, and Africa.

Leveraging cutting-edge automation and testing equipment, coupled with our standardized management, we continuously strive for innovation. Our factory's quality management has been certified compliant with the ISO9001 quality standard.

Build a brand image, strive for a first-class brand, first-class company, and first-class products. Provide every customer with high-quality products, fair prices, timely delivery, and attentive service, in pursuit of long-term, friendly, and mutually beneficial partnerships.

Looking back on the past, living in the present, and envisioning the future, we remain committed to the production principle of continuous innovation and excellence. We are here to ensure your electrical safety!



## PUSH - BUTTON SWITCHES



## SWITCHED SOCKETS

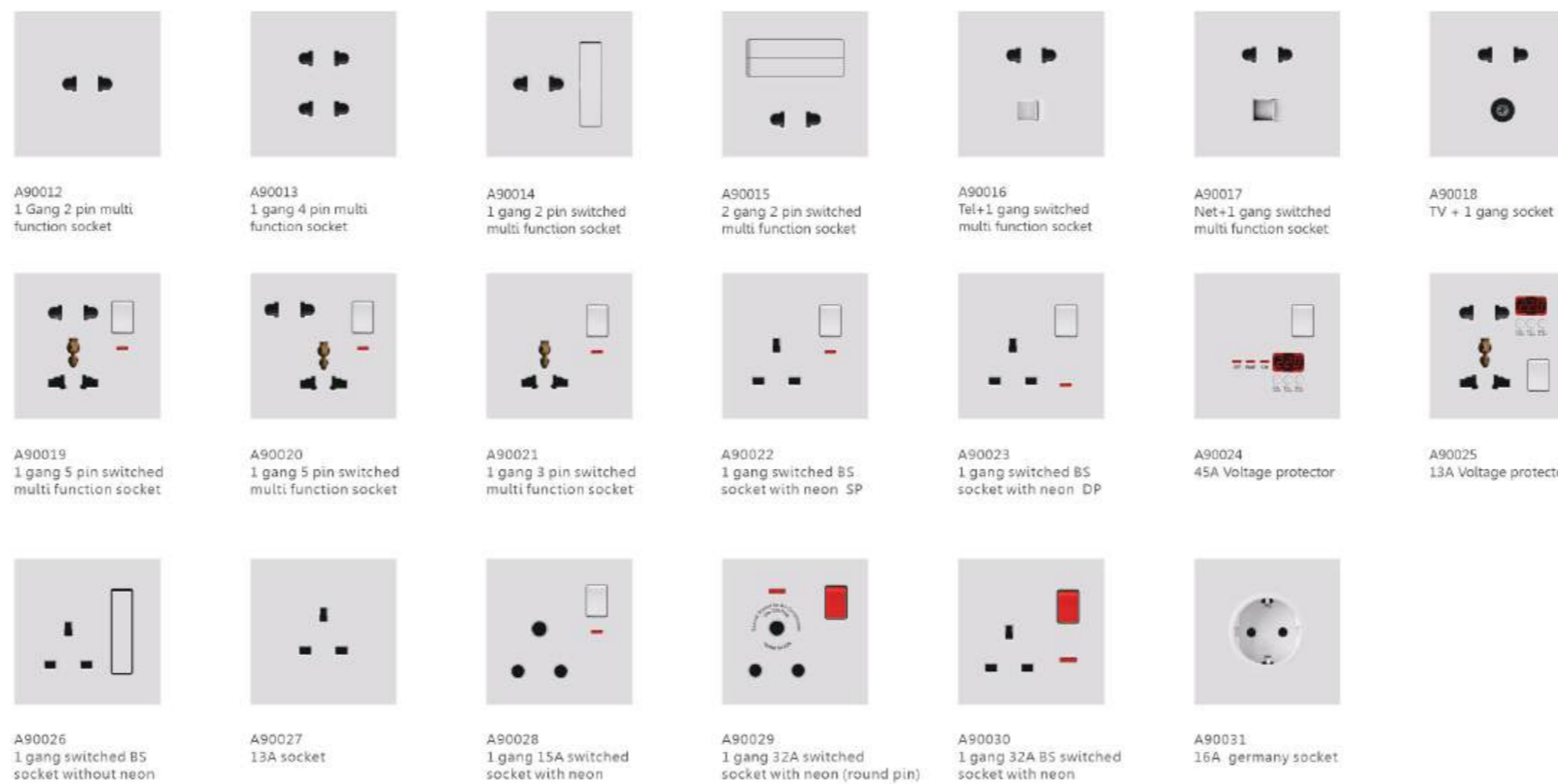

## USB SOCKETS



## TELEVISION TELEPHONE SOCKETS

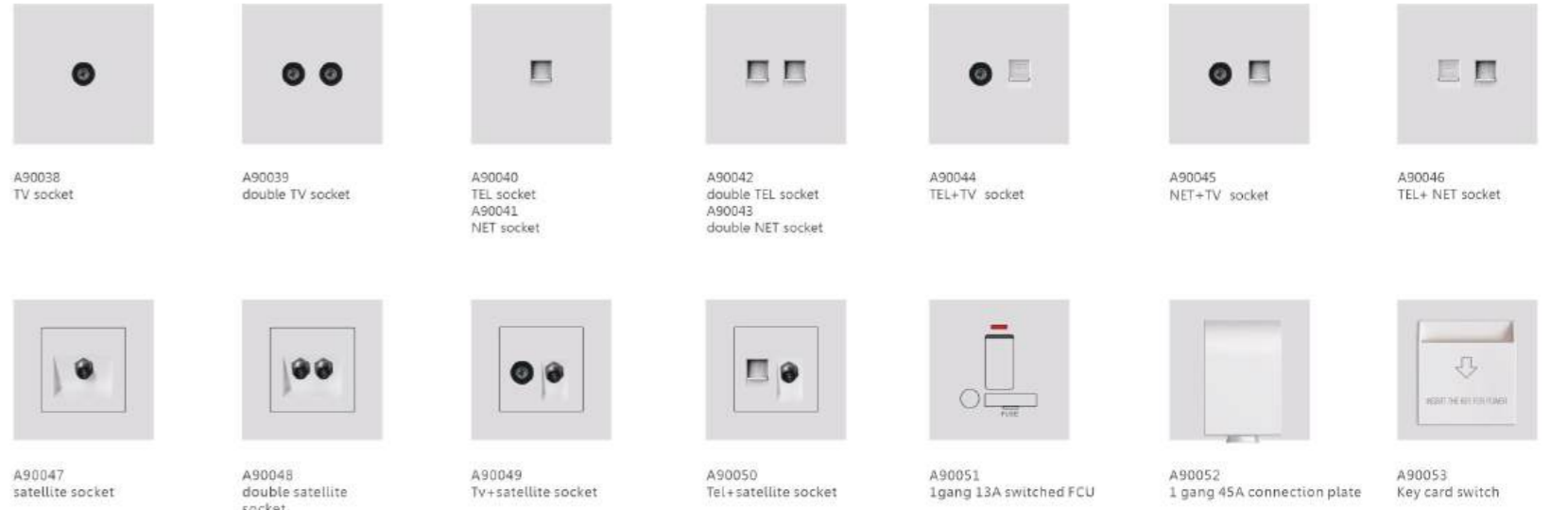

## PUSH-BUTTON SWITCHES



## PUSH ON/OFF ROTARY DIMMERS



## SWITCHED SOCKETS

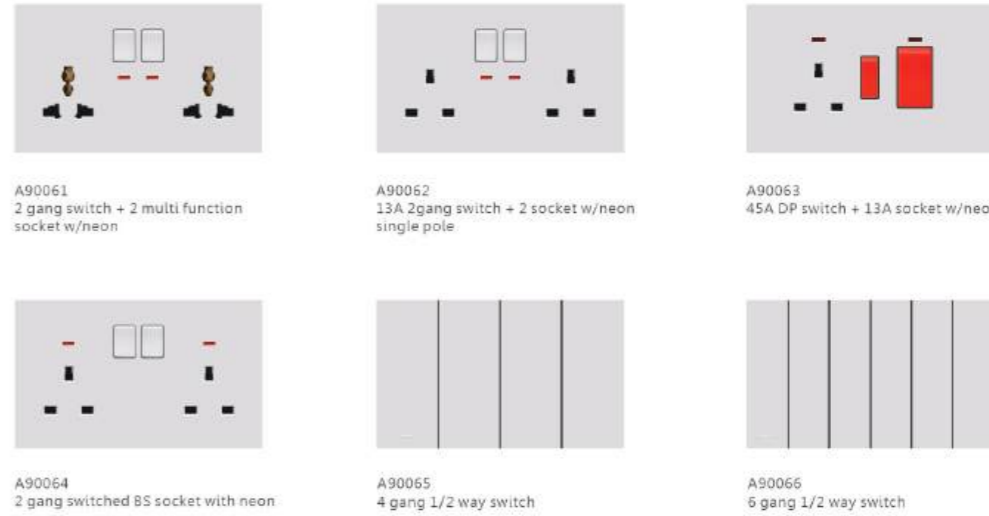

## BLANK PLATE

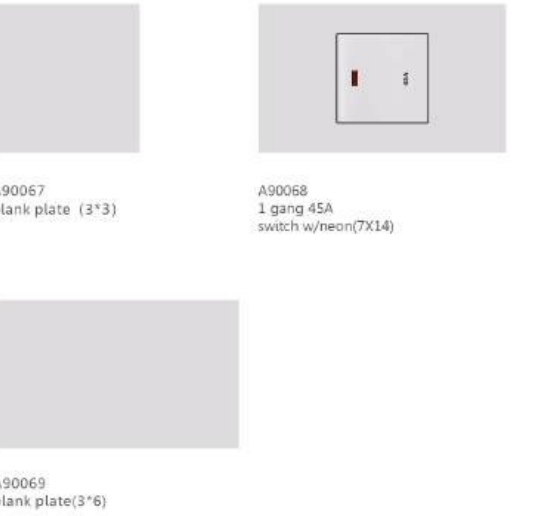

# PRODUCT CERTIFICATION



# OUR OFFICE WORKSHOP



Finish Product Pack Workshop



Inspection and Testing Equipments



Product Mold



Parts Assmble Workshop



Pressing & Injection Workshop



Panel Laser Printing

# ELECTRICAL ACCESSORIES



# A90 SERIES

